

## SWIMEO X | COUNTER-CURRENT SWIMMING



The **SWIMEO X** model is the flush-mounted version in the SWIMEO range. It is designed for integration into a swimming pool during the construction phase.

### A PERFECT COMPROMISE



#### COMFORT

SWIMEO offers the mono-turbine version with the widest flow. At 1.5 m from the discharge outlet, the flow attains a width of 80 cm.



#### POWER

SWIMEO is available in 2 power levels, to suit all swimmers

- **400m<sup>3</sup>/h**: for competitive swimmers who can swim against a 1'30"/100m current. These customers are experienced in triathlons and open-water swimming. They want to improve their performance by training at home.
- **200m<sup>3</sup>/h**: for customers who swim for leisure and to stay in shape. They can improve their well-being by swimming or by using the turbine as a massage solution.

## INTEGRATION

The SWIMEO X turbine is integrated into a recess behind a protective grille (supplied in the integration kit)

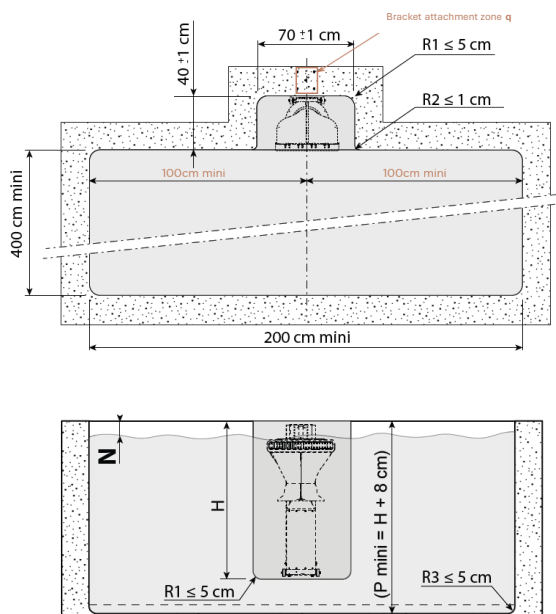

Protective grille of the  
SWIMEO X

## FLOW POWER AND INTEGRATION

The turbine is fully immersed in the water. Its immersion depth affects the power and quality of the flow.

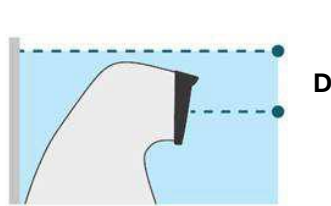

| Turbine depth<br>D | Sensation of<br>power | Comfort of the<br>flow |
|--------------------|-----------------------|------------------------|
| -7 cm              | +++                   | +                      |
| -9 cm              | ++                    | ++                     |
| -11 cm             | +                     | +++                    |

## TECHNICAL SPECIFICATIONS

|                                |  |
|--------------------------------|--|
| Flow power                     | X250: 250m3/h<br>X400: 400m3/h                                       |
| Power supply                   | 230V via the power supply box<br>The motor is supplied with 24V      |
| Electrical power               | X250: 1100W<br>X400: 1600 W  |
| Control                        | Android & IOS smartphone application<br>2 watertight remote controls |
| Product dimensions             | H 1176 x L 760 x W 400 mm  |
| Recess dimensions              | H 1200 x L 700 x W 400 mm  |
| Power supply box<br>dimensions | H 565 x L 275 x W 170 mm   |

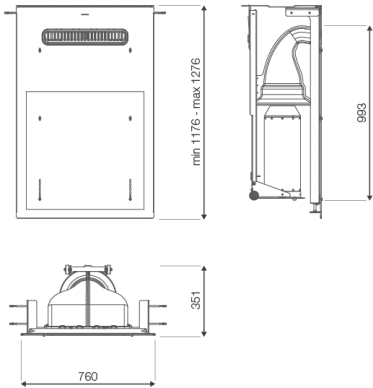

## LOGISTICS

### PALLET 1

- 1 SWIMEO A turbine
- 1 power supply box
- 1 remote control receiver
- 2 watertight remote controls
- 1 Bluetooth antenna
- 1 technical instruction manual

### PALLET 2

- Integration kit  
made of 316 L  
stainless steel

### PALLET DIMENSIONS

- Pallet 1: L80 X W60 X H125 cm
- Pallet 2: L120 X W180 X H30cm

### WEIGHT

- Pallet 1: 70 kg
- Pallet 2: 30 kg

## DOWNLOADS

### CAD FILES

- [SWIMEO X Turbine](#)
- [Power supply box](#)

### Technical documentation

- [SWIMEO A Turbine](#)

### Videos

- [SWIMEO X](#)
- [Integration example](#)

## YOUR CONTACT:

Eric **MIALLARET**  
Sales Development | SWIMEO France  
[Eric.mialaret@sirem.fr](mailto:Eric.mialaret@sirem.fr)  
+33.7.61.15.91.52

**SWIMEO**  
NAGER SANS LIMITE

[www.swimeo.sirem.fr](http://www.swimeo.sirem.fr)